



Vintage Valentine Gift Box

Designed by Candice Windham for *When Creativity Knocks*

Surprise your Valentine with a gift packaged in this super-special Valentine gift box. Tuck in a bag of Kisses, a piece of jewelry, or, my Valentine's favorite, chocolate chip cookies. They'll thank you for going to all the trouble just for them. Don't tell them that it's easy as pie!

Sponsor Products

Makin's Air Dry Clay

Makin's Heart Cutters

Makin's Piercing Tool

Makin's Clay Roller

Deco Art Americana Classic Stencil, Southern Motif

Deco Art Americana Multi-surface Satin, Dark Scarlet

Deco Art Dazzling Metallics: Moss Pearl, Peacock Pearl

Patera 1" Silver Bezel

Judikins Dazzling Diamonds

Beacon Fabri-Tak Adhesive

Beacon 527 Adhesive

Etchall

Etchmask

Kunin Vanilla Plushfelt™

Other Products

Round Paper Mache Box with lid

Small Mirror, 2" x 3"

Pink Scalloped Lace, 2" wide and long enough to surround vintage valentine when gathered

Cream Scalloped Lace 1 ½" wide and approximately 28" long

Velvet Ribbon, 3/8" wide and long enough to wrap around the box

Small Card Stock Scraps, dark red and cream

Transparent half-beads (Dew Drops, The Robin's Nest)

Tools: Paint Brush, Sponges, Needle and Thread, Scissors, Large Circle Cutter (optional), Computer and Printer, repositionable adhesive or painter's tape

Directions

Roll out enough Makin's Air Dry Clay to cut four hearts. When you have rolled the clay to approximately 1/8", use a texture plate to impress a pattern into the clay and cut the largest heart first. Roll the clay again, use a different texture plate and cut the medium and small hearts. Roll out the last bit of clay, press in a third texture plate and cut the smallest heart again. Pierce each heart with the piercing tool to make buttonholes. Set aside to dry.



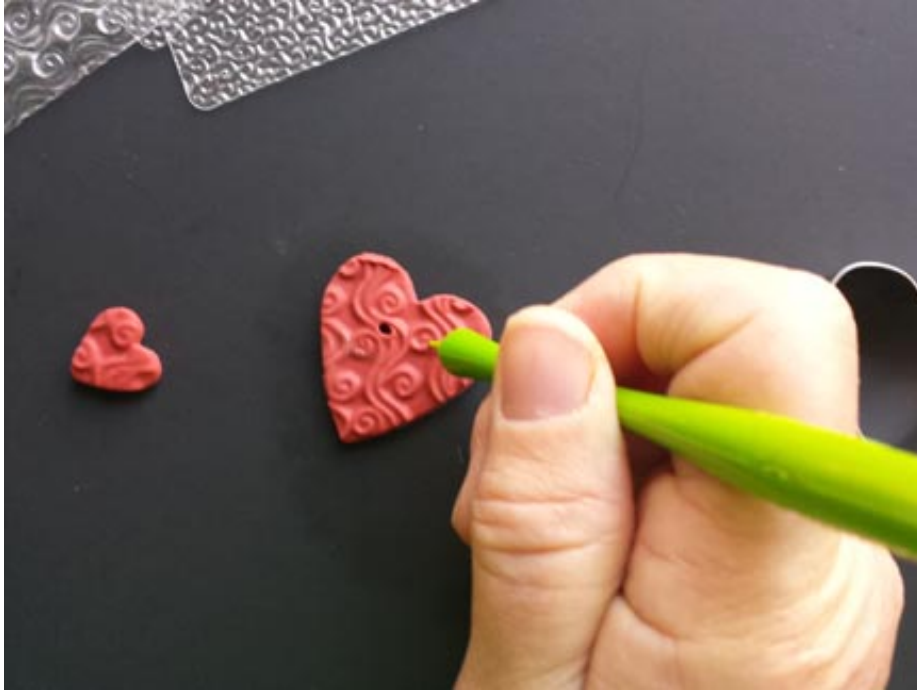

When the hearts are dry, paint each with Dark Scarlett paint. When the paint has dried, coat the top of the hearts with Diamond Glaze. Take one of the smallest hearts and attach it to the inside of the Patera bezel using Diamond Glaze. When the heart is securely attached, fill the bezel to the rim with Diamond Glaze.

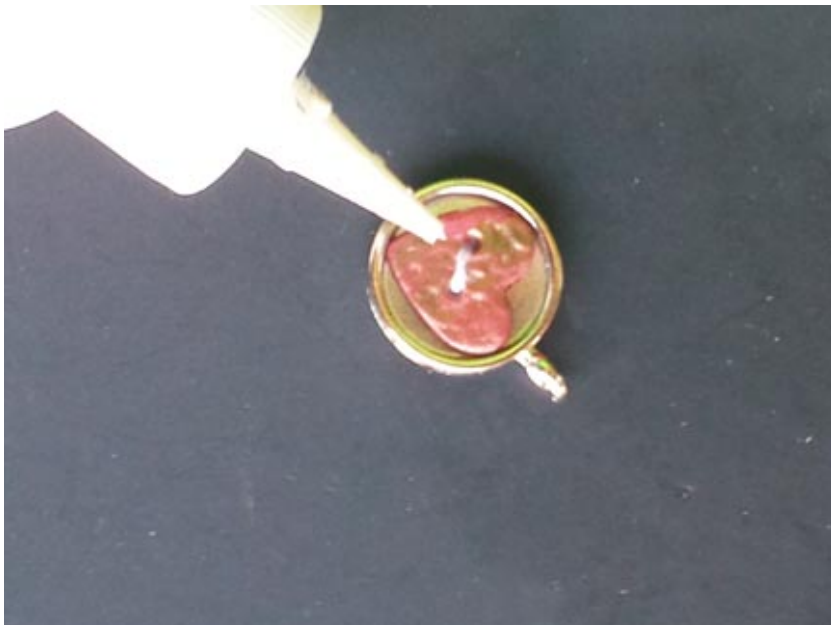

Paint box outside and inside with Moss Pearl. Paint outside box lid with Moss Pearl and inside box lid with Peacock Pearl. Allow to dry.

Apply repositionable adhesive or painter's tape to the stencil and place it on the box side. Use a sponge or stencil brush to apply Peacock Pearl paint in the stencil openings.



Print out a valentine image from the Internet that is approximately six inches wide or two inches smaller than the diameter of the box. Cut out the image as a circle and sponge the edges with Dark Scarlet Satin.

TIP: Apply a very small amount of paint to the sponge, then wipe any excess off on a scrap piece of paper. You want the sponging to be very light and delicate, just to indicate edging.

Fold pink lace so that you have double scallops showing. Use the needle and thread to gather the lace along the fold line. When you have gathered enough to fit slightly under the vintage valentine image, Tack the thread to prevent raveling. Use Fabri-Tak to attach the lace to the back of the valentine and foam squares or large glue dots to attach the image to the box lid. Apply transparent half-beads to the outer edge and velvet ribbon around the rim with Beacon 527 Adhesive. Allow all to dry.

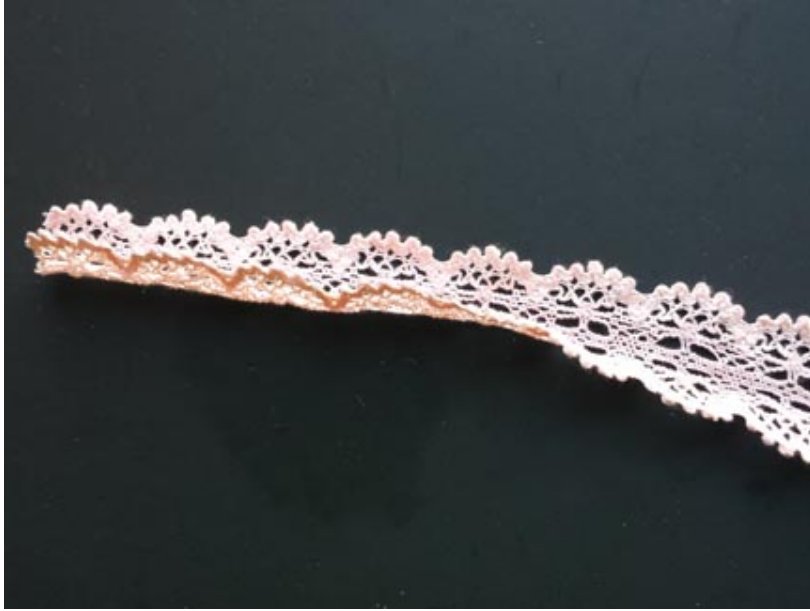

Apply Etchmask to the mirror. Cut a heart shape with a swivel knife and remove the outer edges, leaving the heart covered on the mirror. Apply Etchall heavily to the exposed mirror, spread evenly and allow it to sit for 15 minutes.



Remove the excess Etchall and return it to the bottle to use again. Remove the remaining Etchmask and wash the mirror well. The exposed areas will be etched.



Form a rectangle slightly smaller than the mirror from the cream lace, using Fabri-Tak to hold the folds at each corner and to attach the lace to the back of the mirror. Use foam squares to attach the mirror to the inside of the box lid. Attach the Patera bezel just under the lace square with Beacon 527 adhesive.



Cut a small piece of red cardstock scrap and a piece of white slightly smaller. Sponge the edges of both with Americana Multi-Surface Dark Scarlett Satin. Layer the white onto the red and write *I love this face!* on the white card stock.

Lining

Cut the Kunin felt 2" longer than the circumference of the box and 2" wider than the box height. Fold one longer side down 1" and of the shorter edges down 1" and secure both with Fabri-Tak. On the opposite long edge, cut a 1 1/2" slice every inch. Fold the slices up and hold them in place with painter's tape. Beginning with the cut short end, attach the felt to the box inside with Fabri-tak, about 1" from the top edge of the box. Remove the painter's tape and flatten the slit pieces toward the center of the box bottom.

Cut a piece of chipboard in a circle, about 1/2" smaller than the box bottom. Cover the circle with felt cut about 1/2" to 3/4" larger than the chipboard. Cut slits every 3/4" and fold the felt under the chipboard, attaching it with Fabri-Tak. Place Beacon 527 in the box bottom and push the felt-covered circle into the box bottom.

